

Type SL

Square Lock
Stainless Steel Stripwound Hose



Construction

- Constructed of continuously interlocked Type 302 stainless steel core for exceptional crush and corrosion resistance.
- Extruded PVC, Silicone, Teflon, and Thermoplastic Rubber jackets available upon request.
- Available in brass, galvanized steel and aluminum.



Square Lock Construction

Applications

- Fiber Optics
- Instrumentation
- Sensors
- Recording Instruments
- Temperature Measuring Devices

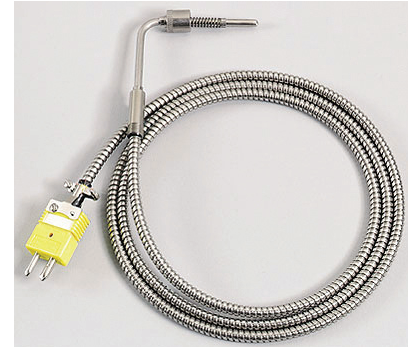

www.nema.org
www.naed.org
www.anametelectrical.com

• RoHS WEEE COMPLIANT

Type SL

Stainless Steel Stripwound Hose

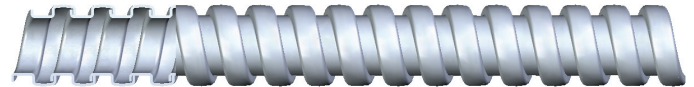

Product Specifications

Ordering Information

Nominal Size		Inside Diameter		Outside Diameter		Approx Inside Bend Radius	Approx Weight lbs.	Standard Reel	
Inches	mm	Inches		Inches				Inches	PER 100 FT.
		MIN.	MAX.	MIN.	MAX.				
1/8	3	.125	.137	.195	.207	1	2.3	1000	460610-0070
5/32	4	.152	.164	.232	.244	1	3.4	1000	460613-0070
3/16	5	.183	.195	.263	.275	1	3.7	1000	460616-0074
7/32	5.6	.206	.221	.291	.306	1	4.1	1000	460619-0070
1/4	6.3	.245	.260	.330	.345	1-1/4	4.8	800	460622-0074
9/32	7	.276	.291	.361	.376	1-1/4	5.4	600	460625-0070
5/16	8	.302	.317	.412	.427	1-1/4	6.7	500	460628-0070
3/8	9	.363	.383	.473	.493	1-1/2	7.9	275	460634-0074
1/2	13	.483	.503	.603	.623	1-1/2	10.8	250	460643-0070
5/8	15	.605	.625	.735	.755	2	12.2	250	460652-0070

NOTE: 1. Other sizes available on special order.
 2. Available in brass, galvanized steel and aluminum.